

## JBF-1 & JBF-2 Series

Our standard JBF-1 and JBF-2 are available in 6 bar and 10 bar. The housings are very suitable for use in brackish and seawater applications and also have a high chemical resistance. The housings are designed according to the PED. The position of the inlet and outlet can be changed to the customers requirements. Options: valves, pressure gauges, automatic air release. LFS calculates the chemical, temperature and pressure influences on the housing.

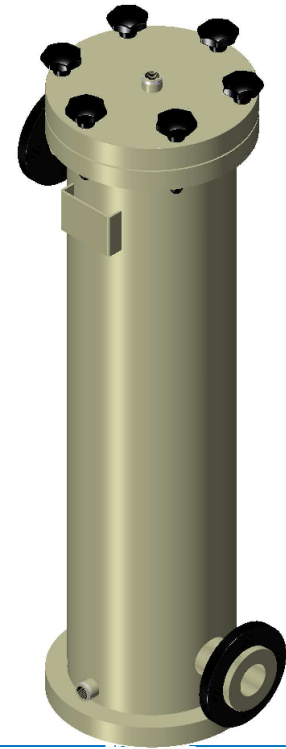

### Ordering code: JBF-2-PP6E-50F

#### Type

JCF = Cartridge  
 JBF = Bagfilter  
 JSF = Strainer  
 JDF = High flow

#### Size Bag

#### Material

PP = Polypropylene  
 HD-PE = Polyethylene  
 PVDF = Polyvinylidene fluoride

#### DN + Connection

F = Flange  
 FT = Female Thread  
 MT = Male Thread

#### O-ring

E = EPDM  
 V = FPM

#### Pressure

6 = 6 bar @ 40° C  
 10 = 10 bar @ 40° C

## Specifications

### Materials

Housing	Polypropylene (PP)
	Polyethylene (HD-PE)
Bolts	Stainless steel
O-ring	EPDM/FPM

### Dimensions

Diameter JBF-1	250 mm
Diameter JBF-2	250 mm
Bag length	Size 1, Size 2

### Other

Inlet/Outlet	DN 25 to 100
	½" to 2"
Drains/vent	½" BSP
Max. Temperature	60° C
Max. Pressure @ 40° C	6 bar or 10 bar

## Benefits

- In- and outlet position can be chosen
- Pressure up to 10 bar
- High chemical resistance
- Can be in environments with high concentrations of salt
- Optimal for use in desalination systems
- Low maintenance
- Easy bag change

*For Clear Solutions*

	<b>JBF-1</b>		<b>JBF-2</b>		
Dimensions in mm	Inlet / outlet DN 32/40/50	Inlet / outlet DN 65/80	Inlet / outlet DN 32/40/50	Inlet / outlet DN 65/80	Inlet / outlet DN 100
A	575	560	905	890	880
B	115	125	115	125	135
C	420	450	420	450	450
D	250	250	250	250	250
E	315	315	315	315	315
F (6 bar/10 bar)	740/770	740/770	1050/1080	1050/1080	1160/1190

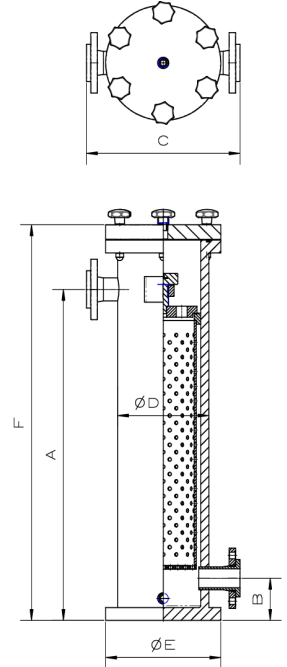

Pos	Name	Material
1	Handwheel	bakelite
2	Washer	Stainless steel
3	Vent 1/2" BSP	PP / HD-PE
4	Lid	PP / HD-PE
5	O-ring	EPDM / FMP
6	Nut	PP / HD-PE
7	Pressure plate	PP / HD-PE
8	Bolt set	Stainless steel
9	Inlet	PP / HD-PE
10	Housing	PP / HD-PE
11	Name tag	PP / HD-PE
12	Outlet	PP / HD-PE
13	Drain 1/2" BSP	PP / HD-PE

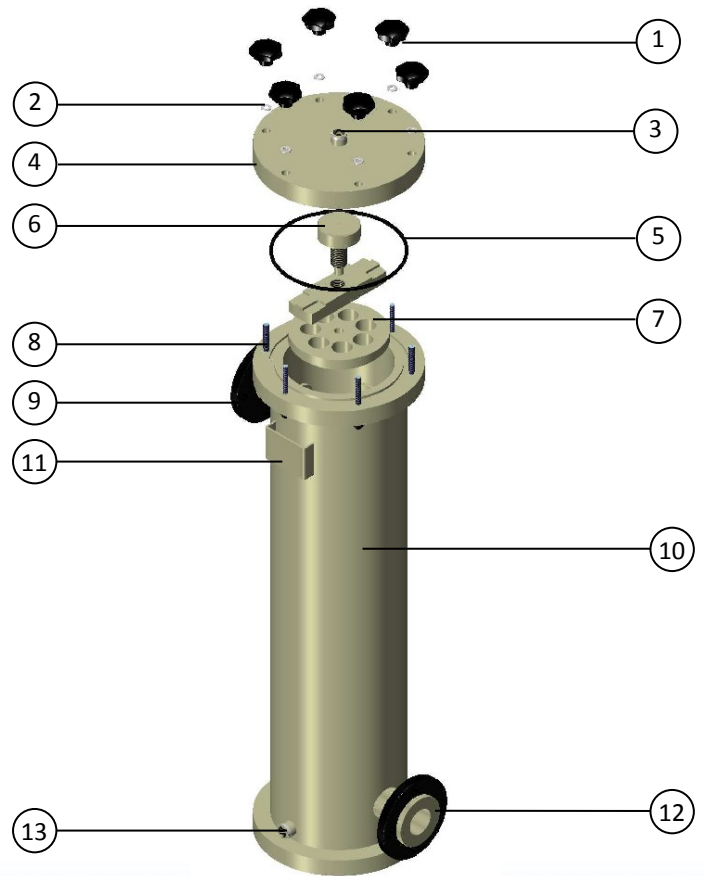

*For Clear Solutions*